

Indoor Cycle / Speedbike

sBike

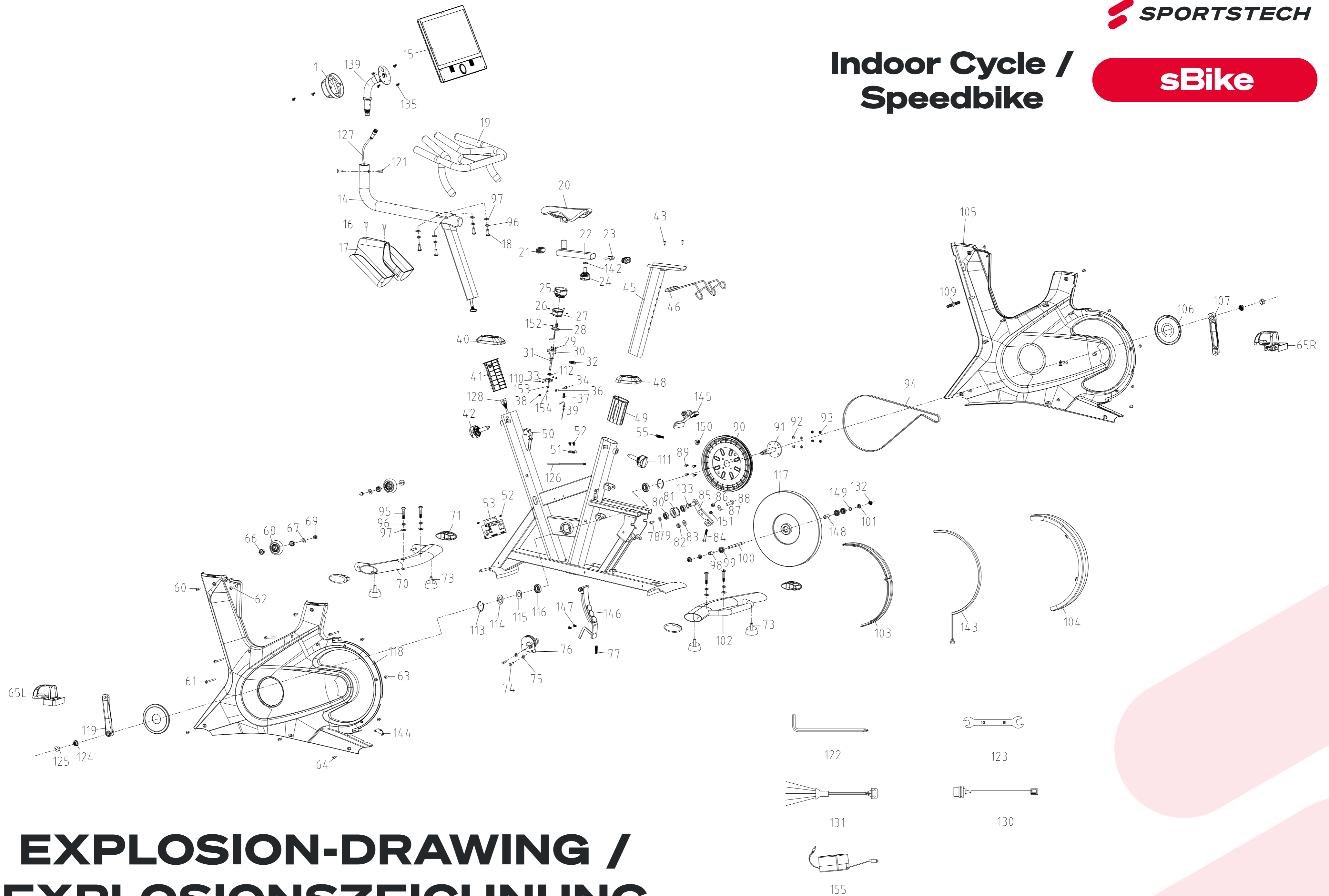

EXPLOSION-DRAWING / EXPLOSIONSZEICHNUNG

SPAREPARTS-OVERVIEW / ERSATZTEILLISTE

No. in explosion drawing	Item No.	Description
1	SP_sBike_01	Console back cover
2	SP_sBike_02	Umbrella head hexagon socket screw M8 x P1.25 x 60L
3	SP_sBike_03	Flat washer D8 x D16 x 1T
4	SP_sBike_04	Console rotation sleeve D11.8 x D8 x 45L
5	SP_sBike_05	Left handed torsion spring D16.5 x 2.25T x 15L
6	SP_sBike_06	Console board
7	SP_sBike_07	Right handed torsion spring D16.5 x 2.25T x 15L
8	SP_sBike_08	Console connection tube
9	SP_sBike_09	Console fixing sleeve
10	SP_sBike_10	Plastic flat mat
11	SP_sBike_11	Locking washer D30 x D20.2 x 2T
12	SP_sBike_12	Double toothed washer 30 x 21 x 1.5
13	SP_sBike_13	Screw socket M20 x P1.5 x D27 x 15L
14	SP_sBike_14	Handlebar tube
15	SP_sBike_15	Console
16	SP_sBike_16	Cross recessed countersunk head screw M5 x P0.8 x 12L
17	SP_sBike_17	Storage bottle
18	SP_sBike_18	Umbrella head hexagon socket screw M8 x P1.25 x 20L
19	SP_sBike_19	Front handlebar
20	SP_sBike_20	Saddle
21	SP_sBike_21	Flat oval plug 25 x 50
22	SP_sBike_22	Slide tube
23	SP_sBike_23	Slide tube fixing screw 20 x 40
24	SP_sBike_24	Slide tube knob
25	SP_sBike_25	Brake knob
26	SP_sBike_26	Shot head cross self tapping cutting tail nail ST2.9 x 6L
27	SP_sBike_27	Knob fixing seat
28	SP_sBike_28	Shuttle board
29	SP_sBike_29	Nylon nut M4 x P0.7
30	SP_sBike_30	Umbrella head cross screw M4 x P0.7 x 10L
31	SP_sBike_31	Brake rod
32	SP_sBike_32	Brake rod decorative ring
33	SP_sBike_33	Brake rod fixing seat up
34	SP_sBike_34	Umbrella head cross screw M5 x P0.8 x 35L
35	SP_sBike_35	Brake rod
36	SP_sBike_36	Brake line sliding sleeve D10 x D5 x 22L
37	SP_sBike_37	Brake spring D11.4 x D1.4 x 21.5L
38	SP_sBike_38	Nylon nut M5 x P0.8
39	SP_sBike_39	Brake line 700L
40	SP_sBike_40	Handlebar tube cover
41	SP_sBike_41	Handlebar tube bush
42	SP_sBike_42	Handlebar pull pin
43	SP_sBike_43	Umbrella head cross screw M5 x P0.8 x 16L
44	SP_sBike_44	Ball head cross screw M5 x P0.8 x 10 L
45	SP_sBike_45	Seat tube
46	SP_sBike_46	The dumbbell rack
47	SP_sBike_47	Umbrella head cross screw M4 x P0.7 x 8L
48	SP_sBike_48	Seat tube cover
49	SP_sBike_49	Seat tube bush
50	SP_sBike_50	Frame
51	SP_sBike_51	Induction rod fixing seat
52	SP_sBike_52	Umbrella head cross screw M5 x 12L
53	SP_sBike_53	Controller
54	SP_sBike_54	Umbrella head cross tapping tail screw ST2.9 x 8L
55	SP_sBike_55	Brake rod spring D9.8 x D15.2 x D1.2 x 50.4L
56	SP_sBike_56	Nylon nut M8 x 7T
57	SP_sBike_57	Flat washer D8 x D19 x 2T
58	SP_sBike_58	Brake block assemble
59	SP_sBike_59	Hexagon bolt M8 x P1.25 x 55L
60	SP_sBike_60	Umbrella head cross screw M5 x P0.8 x 10L
61	SP_sBike_61	Umbrella head cross tapping screw ST3.9 x 50L
62	SP_sBike_62	Umbrella head cross tapping screw ST3.9 x 25L
63	SP_sBike_63	Umbrella head cross tapping screw ST3.9 x 16L
64	SP_sBike_64	Umbrella head cross screw M5 x 12L
65	SP_sBike_65L	Pedal left
65	SP_sBike_65R	Pedal right
66	SP_sBike_66	Bearing 608 2ZZ
67	SP_sBike_67	Flat washer D8 x D14 x 2T
68	SP_sBike_68	Roller wheel
69	SP_sBike_69	Nylon nut M8 x P1.25 x 7T
70	SP_sBike_70	Front stabilizer
71	SP_sBike_71	Front stabilizer plug
72	SP_sBike_72	LED light strap
73	SP_sBike_73	Adjusting foot pad
74	SP_sBike_74	Hex screw M5 x P0.8 x 12L
75	SP_sBike_75	Flat washer D5.5 x D12 2T
76	SP_sBike_76	Motor

No. in explosion drawing	Item No.	Description
77	SP_sBike_77	Spring D1 x D8.5 x 48L
78	SP_sBike_78	Hex fastener screw M6 x P1.0 x 10L
79	SP_sBike_79	Flat washer D6.5 x D13 x 1.5L
80	SP_sBike_80	Bearing 6000 2ZZ
81	SP_sBike_81	Plastic adhesion wheel
82	SP_sBike_82	Nylon nut M8 x 7T
83	SP_sBike_83	Flat washer D8 x D19 x 2T
84	SP_sBike_84	Hexagon bolt M6 x P1.0 x 55L
85	SP_sBike_85	Adhension rod
86	SP_sBike_86	Nylon nut M6 x P1.0 x 5.5T
87	SP_sBike_87	Teflon gasket D8.5 x D25 x 0.5
88	SP_sBike_88	Hexagon socket flat head screws M8 x 20L
89	SP_sBike_89	Hexagon bolt M6 x P1.0 x 16L
90	SP_sBike_90	Plastic belt tray
91	SP_sBike_91	Center axile D20 x 174L
92	SP_sBike_92	Spring washer D6.1 x 1.6T
93	SP_sBike_93	Nylon nut M6 x P1.0 x 5.5T
94	SP_sBike_94	More groove belt 480J
95	SP_sBike_95	Umbrella head hexagon socket screw M8 x P1.25 x 50L
96	SP_sBike_96	Heavy type spring washer D8.1 x 14.5 x 2.4T
97	SP_sBike_97	Flat washer D8 x D19 x 2T
98	SP_sBike_98	Flywheel sleeve D14 x D10.5
99	SP_sBike_98_V1	Flywheel sleeve
99	SP_sBike_99	Bearing 6000 2RS
100	SP_sBike_100	Flywheel spindle
101	SP_sBike_100_V1	Flywheel axies
101	SP_sBike_101	Hexagon nut 26 x 4.5L
102	SP_sBike_102	Back stabilizer
103	SP_sBike_103	Light strap fixing seat
104	SP_sBike_104	Translucent lamp shade
105	SP_sBike_105	Outer shell lower cover
106	SP_sBike_106	Crank decroative cover
107	SP_sBike_107	Crank right
108	SP_sBike_108	Magnetic control group
109	SP_sBike_109	Shell bar D6 x 36.6L
110	SP_sBike_110	Umbrella head cross screw M4 x P0.7 x 8L
111	SP_sBike_111	Seat tube pull pin
112	SP_sBike_112	Brake tube plug
113	SP_sBike_113	Circlip for shaft D18.5 x D22.5 x 1T
114	SP_sBike_114	Flat washer D20.3 x D30 x 0.5T
115	SP_sBike_115	Wavy washer D20.5 x D30 x 0.3T
116	SP_sBike_116	Bearing 6004 2RS
117	SP_sBike_117	Flywheel
118	SP_sBike_118	Outer shell top cover
119	SP_sBike_119	Crank left
120	SP_sBike_120	Torsional spring fixing plate
121	SP_sBike_121	Cross recessed countersunk head screw M6 x P1.0 x 8L
122	SP_sBike_122	Hexgaon wrench
123	SP_sBike_123	Open spanner
124	SP_sBike_124	Hexagon flange nuts with teeth M10 x P1.25 x 10T
125	SP_sBike_125	Leg decorative cover
126	SP_sBike_126	Induction rod lower cable
127	SP_sBike_127	Upper communication wire
128	SP_sBike_128	Lower communication wire
129	SP_sBike_129	LED light strap
130	SP_sBike_130	DC wire
131	SP_sBike_131	Motor connection wire
132	SP_sBike_132	Hexagon flange nuts with teeth 26 x 7T
133	SP_sBike_133	Wavy washer D10.2 x D13 x 0.3T
134	SP_sBike_134	Brake block
135	SP_sBike_135	Umbrella head cross screw M5 x P0.8 x 16L
136	SP_sBike_136	Adaptor 12V
139	SP_sBike_139	Console connection tube set
142	SP_sBike_142	Flat washer D14 x 25
143	SP_sBike_143	LED light strap set
144	SP_sBike_144	DC wirer cover
145	SP_sBike_145	Rear Brake set
146	SP_sBike_146	Magnetic control group set
147	SP_sBike_147	Screw M5 x 12
148	SP_sBike_148	Sleeve
149	SP_sBike_149	Bearing 6300-2RS
150	SP_sBike_150	Sensor
151	SP_sBike_151	Hex nut M6 x P1.0 x 5T
152	SP_sBike_152	Umbrella head cross self-tapping cutting tail screw ST2.9 x 8
153	SP_sBike_153	Flat washer D8 x D19 x 2T
154	SP_sBike_154	Circlip for shaft D8
Not in drawing	SP_sBike_Manual	Manual
Not in drawing	SP_sBike_Screw set	Screw set